

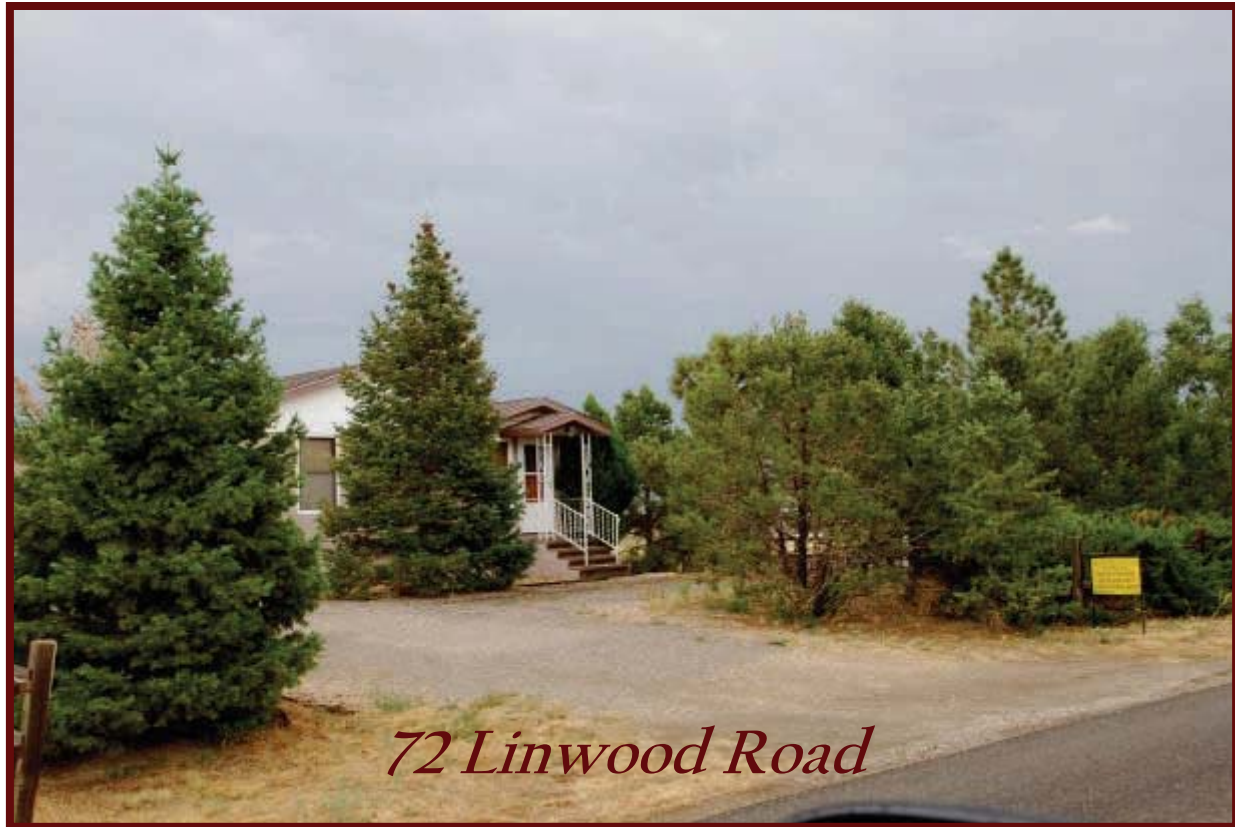

Kiowa Land and Sales

"Making a difference to the land and the people"



72 Linwood Road

2000' 4 bed/2 bath home with attached garage...

Well kept property- just under 3/4 acre of land with beautiful mature trees is priced to sell and ready for new owners to move in... This home is nicely designed for lots of living. The kitchen, dining area, large living room, 2 bedrooms, and 1 bath are on the 1000' main floor while the 1000' downstairs boasts another large family room, 2 more bedrooms, a second bath, and lots of closet space. The home stays comfortable and heating bills stay reasonable with a pellet stove upstairs and a wood stove downstairs to complement electric baseboard heat.

Conveniently close to town but feeling like the country, mature trees and pole fence make the space feel private and beautiful. This home is well-kept and ready for new occupants.

Stick built home with lots of space - Awesome views!!!

\$115,000

7L

sales@kiowaland.com

NM

Toll Free 877.704.4077

X

Norman "Punch" Hennigan, Qualifying Broker

PO Box 5, 116 South Second, Raton, NM 87740

Office 575.445.4077 ♦ www.kiowaland.com ♦ Fax 575.445.4079

1000' Main Floor



Welcome to comfort, convenience, and lots of space... A lovely and practical entry foyer welcomes all who enter. From the large living room one can enjoy the outdoors through a large wall of windows. The passive solar windows let in the winter sun while keeping out the cold. The pellet stove adds both ambiance and heat during the winter...

The kitchen & dining area are just beyond the living room in a comfortable open layout. The stairs next to kitchen lead to the backyard, deck and patio and to the downstairs rooms. Just off the dining area, a set of doors lead to the upstairs bedrooms and bath.



The two upstairs bedrooms are a good size and have lots of closet space. One has a window facing the back yard with views east to Johnson Mesa, the other is on the front of the house with beautiful trees just outside.



The bathroom in conjunction with the washer/ dryer completes the main floor allowing family members to stay on the main floor when the need arises.



1000' Downstairs



The downstairs floor of the home is a beautifully finished basement but with large slanted windows it hardly feels like a basement. The large family room has a wood stove to help heat the home.

The 2 bedrooms have a lot of closet space and views outside through the family room. Ample closet space can be found in the bathroom off the family room.



With plenty of space for family, visitors, a home office, hobbies - this home is ready for whatever you need, whatever your heart desires...

Construction of this home including the insulated 2 car garage on the north wall of the home, the basement, the south-facing passive solar windows, the pellet stove, and the wood stove all make this a comfortable home to heat...

Now let's go to the back yard... This day we saw rain instead of Johnson Mesa!



Views galore...



The backyard has a nice deck, patio, and plenty of room for family, pets, and privacy.

The back yard has nice views from Brush Canyon on the side of Bartlett Mesa to Johnson Mesa. A small shed is ready for your garden tools!



The yard is nicely fenced giving the property a bit of protection and a visual boundary. The mature trees welcome you home.



Come park your car in the garage and make this your home...





"Making a difference to the land and the people"



Welcome...

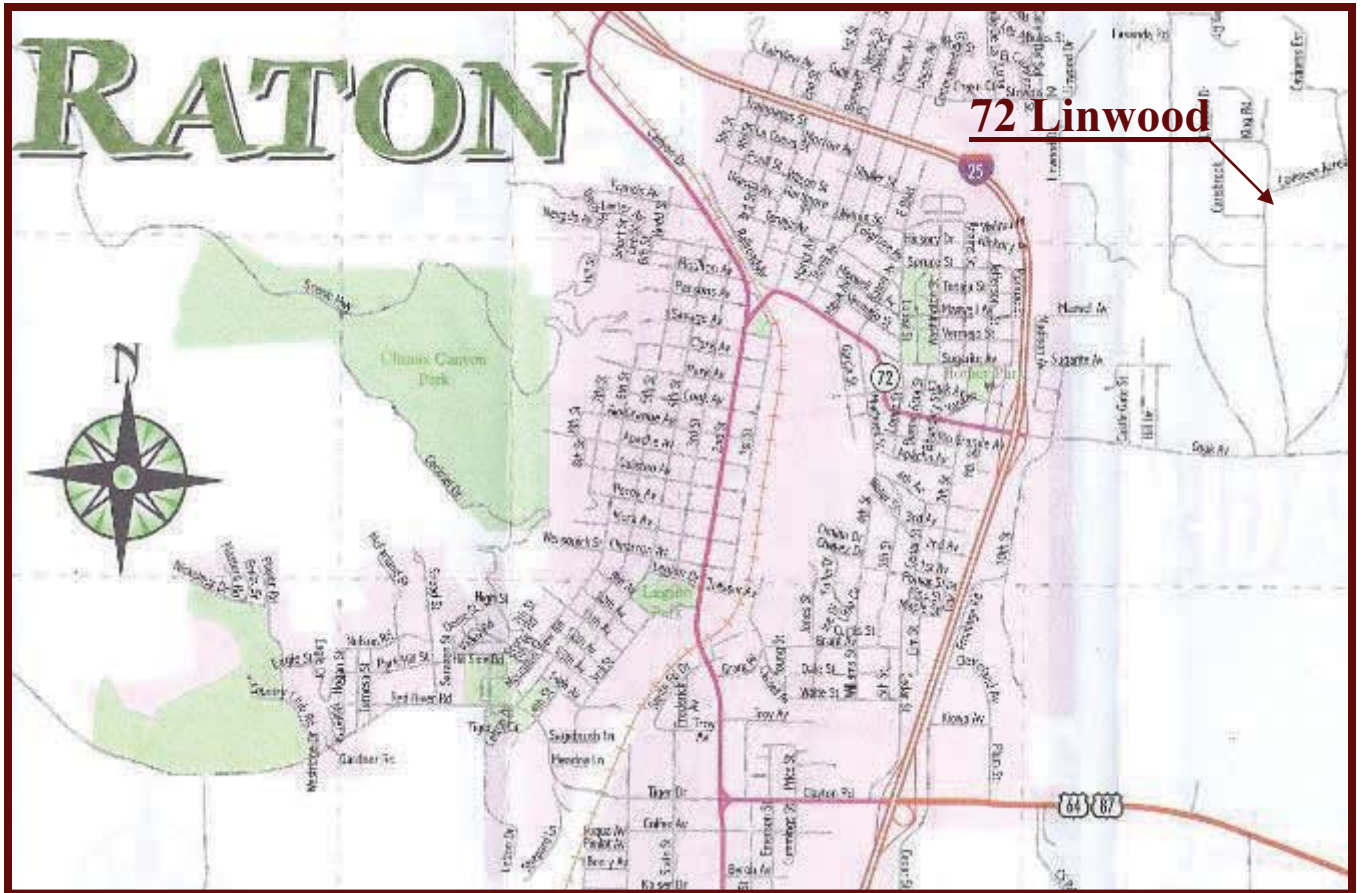

7L

sales@kiowaland.com

NM

Toll Free 877.704.4077



Norman "Punch" Hennigan, Qualifying Broker

PO Box 5, 116 South Second, Raton, NM 87740

Office 575.445.4077 ♦ www.kiowaland.com ♦ Fax 575.445.4079